



# Heyco® Nylon PCB Supports

## Shorty PCB Supports



PANEL DIMENSIONS				PCB DIMENSIONS				PART NO.	DESCRIPTION	PART DIMENSIONS					
Maximum Thickness	Mounting Hole Diameter		Maximum Thickness	Mounting Hole Diameter		Natural	A Spacing			B Head Length		C Foot Length			
in.   mm.	in.   mm.	mm.	in.   mm.	in.   mm.	mm.			in.   mm.	mm.	in.   mm.	mm.	in.   mm.	mm.		
<b>SS B Series</b>															
.06	1,6	.125	3,2	.06	1,6	.125	3,2	3715	SS B 1/8	.13	3,2				
								3716	SS B 3/16	.19	4,8				
								3717	SS B 1/4	.25	6,4				
								3718	SS B 5/16	.31	7,9				
								3719	SS B 3/8	.38	9,5				
								3720	SS B 7/16	.44	11,1	.15	3,8	.14	3,6
								3721	SS B 1/2	.50	12,7				
								3722	SS B 9/16	.56	14,3				
								3723	SS B 5/8	.63	15,9				
								3724	SS B 3/4	.75	19,0				

Standard color natural.

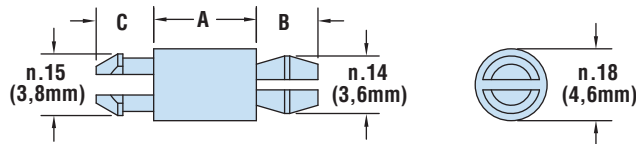

- Locking spacer **eliminates the need for additional hardware** in mounting P.C. Boards.
- Ideal for mounting in neutral chassis or stacking in tiers.
- Sizes for standard and metric mounting holes.

## Metric PCB Supports

PANEL DIMENSIONS				PCB DIMENSIONS				PART NO.	DESCRIPTION	PART DIMENSIONS					
Maximum Thickness	Mounting Hole Diameter		Maximum Thickness	Mounting Hole Diameter		Natural	A Spacing			B Head Length		C* Foot Length			
in.   mm.	in.   mm.	mm.	in.   mm.	in.   mm.	mm.			in.   mm.	mm.	in.   mm.	mm.	in.   mm.	mm.		
<b>SS M Series</b>															
.06	1,6	.157	4,0	.06	1,6	.157	4,0	3650	SS M 3	.12	3,0				
								3651	SS M 4	.16	4,0				
								3653	SS M 6	.24	6,0				
								3654	SS M 8	.32	8,0				
								3655	SS M 10	.39	10,0	.19	4,8	.13	3,2
								3656	SS M 12	.47	12,0				
								3657	SS M 14	.55	14,0				
								3658	SS M 16	.63	16,0				
								3659	SS M 18	.71	18,0				

Standard color natural.

\*Extension beyond .062" (1,6 mm) thick panel.

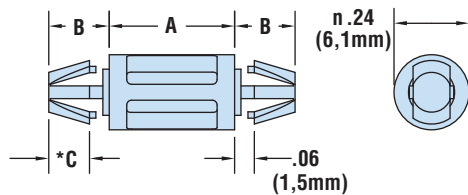

Material: Nylon 6/6  
 Flammability Rating: 94V-2  
 Temperature Range: 32°F (0°C) to 185°F (85°C)

Quick Specs