

"Stay Connected" with



HEYware Products

a PennEngineering® Company



HEYClip™ Nylon Push Screws

- Installs like a traditional nylon push rivet but removable/reusable
- Remove by unscrewing like a traditional threaded fastener
- Saves time by installing with finger-tip pressure
- Low insertion force but high extraction force

Threaded Mounting Hole	PART NO.		DESCRIPTION	PART DIMENSIONS									
	Natural	Black		A Head Height		B Overall Length		C Head Diameter		Push In Force Max.		Pull Out Force Min.	
				in.	mm.	in.	mm.	in.	mm.	LB	N	LB	N
M3	11500	11500B	PS-M3X0.5X8.5MM	.10	2,5	.33	8,5	.22	5,5	7	30	11	50
M4	11501	11501B	PS-M4X0.5X9.5MM	.12	3,0	.37	9,5	.29	7,3	8	35	20	90
M5	11502	11502B	PS-M5X0.5X12.5MM	.14	3,5	.49	12,5	.33	8,5	8	35	22	100
M6	11503	11503B	PS-M6X0.5X15.0MM	.18	4,5	.59	15,0	.39	10,0	8	35	27	120
M8	11504	11504B	PS-M8X0.5X18.0MM	.22	5,5	.71	18,0	.51	13,0	9	40	31	140

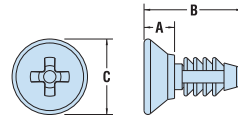

HEYClip™ Nylon Push Screws – HPLP Series

Style	Threaded Hole Type		Clearance Hole ±.015 (0,4mm)		Min Panel Thickness E		Max Panel Thickness F		PART NO.		DESCRIPTION	PART DIMENSIONS									
	Imperial	Metric	in.	mm.	in.	mm.	in.	mm.	Natural	Black		A Head Height		B Overall Length		C Head Diameter		Push In Force Max.		Pull Out Force Min.	
												in.	mm.	in.	mm.	in.	mm.	lbf	N	lbf	N
1	#4	M3	.083	2,1	.14	3,6	.24	6,0	15500	15500B	.07	1,7	.32	8,0	.22	5,5	6,7	30	11,2	50	
					.19	4,8	.32	8,0	15502	15502B											
					.23	5,8	.39	10,0	15504	15504B											
					.23	5,8	.39	10,0	15504	15504B											
					.38	9,7	.47	12,0	15506	15506B											
	#8	M4	.125	3,2	.20	5,1	.30	7,7	15508	15508B	.11	2,7	.39	10,0	.33	8,4	7,9	35	20,2	90	
					.26	6,6	.38	9,7	15510	15510B											
					.31	7,9	.46	11,7	15512	15512B											
					.41	10,4	.54	13,7	15514	15514B											
					.53	13,5	.70	17,7	15516	15516B											
	#10	M5	.161	4,1	.23	5,8	.33	8,4	15518	15518B	.11	2,7	.47	12,0	.37	9,3	7,9	35	22,5	100	
					.29	7,4	.41	10,4	15520	15520B											
					.35	8,9	.49	12,4	15522	15522B											
					.43	10,9	.65	16,4	15524	15524B											
					.43	10,9	.65	16,4	15524	15524B											
	1/4-20	M6	.201	5,1	.24	6,1	.37	9,4	15526	15526B	.13	3,3	.55	14,0	.44	11,3	7,9	35	27,0	120	
					.30	7,6	.45	11,4	15528	15528B											
					.44	11,2	.61	15,4	15530	15530B											
					.57	14,5	.80	20,4	15532	15532B											
					.57	14,5	.80	20,4	15532	15532B											
	5/16-18	M8	.250	6,4	.43	10,9	.57	14,5	15534	15534B	.19	4,7	.79	20,0	.62	15,8	12,4	55	40,5	180	
					.58	14,7	.77	19,5	15536	15536B											
					.73	18,5	.96	24,5	15538	15538B											
					.88	22,4	1.16	29,5	15540	15540B											
.88					22,4	1.16	29,5	15540	15540B												

- Can be used in a Clearance hole or a threaded hole (see chart). Removable when used in a threaded hole.
- Product line offers a wide range of assembled panel thicknesses from .03" to 1.16" and hole sizes from .083" to .250" Dia.

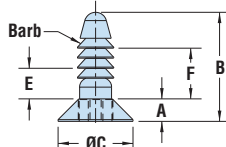

Style 1

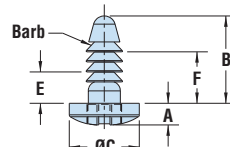

Style 2

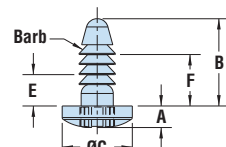

Style 3

Quick Specs

Material Nylon 6/6
 Flammability Rating 94V-2
 Temperature Range 40°F (-40°C) to 185°F (85°C)

“Stay Connected” with



HEYware Products

a PennEngineering® Company

HEYClip™ Nylon Push Screws – HPLP Series (continued)

Style	Threaded Hole Type		Clearance Hole ±.015 (0,4mm)		Min Panel Thickness E		Max Panel Thickness F		PART NO.		DESCRIPTION	PART DIMENSIONS									
									Natural	Black		A Head Height		B Overall Length		C Head Diameter		Push In Force Max.		Pull Out Force Min.	
	Imperial	Metric	in.	mm.	in.	mm.	in.	mm.				in.	mm.	in.	mm.	in.	mm.	lbf	N	lbf	N
2	#4	M3	.083	2,1	.03	0,7	.16	4,0	15542	15542B	HPLPB 083-024	.09	2,4	.24	6,0	.22	5,6	6.7	30	11.2	50
					.12	3,0	.24	6,0	15544	15544B	HPLPB 083-032			.32	8,0						
					.18	4,6	.32	8,0	15546	15546B	HPLPB 083-039			.39	10,0						
					.26	6,7	.39	10,0	15548	15548B	HPLPB 083-047			.47	12,0						
	#8	M4	.125	3,2	.10	2,6	.22	5,7	15550	15550B	HPLPB 125-032	.12	3,1	.32	8,0	.32	8,0	9	40	27.0	120
					.04	1,1	.24	6,2	15552	15552B	HPLPB 125-033			.33	8,5						
					.15	3,7	.30	7,7	15554	15554B	HPLPB 125-039			.39	10,0						
					.18	4,6	.38	9,7	15556	15556B	HPLPB 125-047			.47	12,0						
					.25	6,4	.46	11,7	15558	15558B	HPLPB 125-055			.55	14,0						
					.32	8,1	.54	13,7	15560	15560B	HPLPB 125-063			.63	16,0						
	#10	M5	.161	4,1	.08	2,0	.21	5,4	15562	15562B	HPLPB 161-035	.15	3,7	.35	9,0	.37	9,5	10.1	45	33.7	150
					.14	3,6	.25	6,4	15564	15564B	HPLPB 161-039			.39	10,0						
					.12	3,0	.33	8,4	15566	15566B	HPLPB 161-047			.47	12,0						
					.24	6,1	.45	11,4	15568	15568B	HPLPB 161-059			.59	15,0						
					.28	7,1	.49	12,4	15570	15570B	HPLPB 161-063			.63	16,0						
					.36	9,1	.57	14,4	15572	15572B	HPLPB 161-071			.71	18,0						
					.38	9,7	.65	16,4	15574	15574B	HPLPB 161-079			.79	20,0						
					1/4-20	M6	.201	5,1	.10	2,6	.21			5,4	15576						
	.17	4,3	.29	7,4					15578	15578B	HPLPB 201-047	.47	12,0								
	.12	3,0	.35	8,9					15580	15580B	HPLPB 201-053	.53	13,5								
	.18	4,6	.41	10,4					15582	15582B	HPLPB 201-059	.59	15,0								
	.16	4,1	.45	11,4					15584	15584B	HPLPB 201-063	.63	16,0								
	.29	7,4	.53	13,4					15586	15586B	HPLPB 201-071	.71	18,0								
	.38	9,7	.61	15,4					15588	15588B	HPLPB 201-079	.79	20,0								
.53	13,5	.80	20,4	15590					15590B	HPLPB 201-098	.98	25,0									
5/16-18	M8	.250	6,4	.07	1,8	.26	6,5	15592	15592B	HPLPB 250-047	.24	6,0	.47	12,0	.63	16,0	12.4	55	47.3	210	
				.14	3,5	.41	10,5	15594	15594B	HPLPB 250-063			.63	16,0							
				.21	5,3	.49	12,5	15596	15596B	HPLPB 250-071			.71	18,0							
				.32	8,0	.57	14,5	15598	15598B	HPLPB 250-079			.79	20,0							
				.51	13,0	.77	19,5	15600	15600B	HPLPB 250-098			.98	25,0							
				.70	17,7	.96	24,5	15602	15602B	HPLPB 250-118			1.18	30,0							
				.90	22,9	1.16	29,5	15604	15604B	HPLPB 250-138			1.38	35,0							
				3	#4	M3	.083	2,1	.03	0,7			.16	4,0							15606
.12	3,0	.24	6,0						15608	15608B	HPLPC 083-032	.32	8,0								
.18	4,6	.32	8,0						15610	15610B	HPLPC 083-039	.39	10,0								
.26	6,7	.39	10,0						15612	15612B	HPLPC 083-047	.47	12,0								
#8	M4	.125	3,2		.10	2,6	.22	5,7	15614	15614B	HPLPC 125-032	.12	3,1	.32	8,0	.32	8,0	9	40	27.0	120
					.04	1,1	.24	6,2	15616	15616B	HPLPC 125-033			.33	8,5						
					.15	3,7	.30	7,7	15618	15618B	HPLPC 125-039			.39	10,0						
					.18	4,6	.38	9,7	15620	15620B	HPLPC 125-047			.47	12,0						
					.25	6,4	.46	11,7	15622	15622B	HPLPC 125-055			.55	14,0						
					.32	8,1	.54	13,7	15624	15624B	HPLPC 125-063			.63	16,0						
#10	M5	.161	4,1		.08	2,0	.21	5,4	15626	15626B	HPLPC 161-035	.15	3,7	.35	9,0	.37	9,5	10.1	45	33.7	150
					.14	3,6	.25	6,4	15628	15628B	HPLPC 161-039			.39	10,0						
					.12	3,0	.33	8,4	15630	15630B	HPLPC 161-047			.47	12,0						
					.24	6,1	.45	11,4	15632	15632B	HPLPC 161-059			.59	15,0						
					.28	7,1	.49	12,4	15634	15634B	HPLPC 161-063			.63	16,0						
					.36	9,1	.57	14,4	15636	15636B	HPLPC 161-071			.71	18,0						
					.38	9,7	.65	16,4	15638	15638B	HPLPC 161-079			.79	20,0						
					1/4-20	M6	.201	5,1	.10	2,6	.21			5,4	15640						
.17	4,3	.29	7,4						15642	15642B	HPLPC 201-047	.47	12,0								
.12	3,0	.35	8,9						15644	15644B	HPLPC 201-053	.53	13,5								
.18	4,6	.41	10,4						15646	15646B	HPLPC 201-059	.59	15,0								
.16	4,1	.45	11,4						15648	15648B	HPLPC 201-063	.63	16,0								
.29	7,4	.53	13,4						15650	15650B	HPLPC 201-071	.71	18,0								
.38	9,7	.61	15,4						15652	15652B	HPLPC 201-079	.79	20,0								
.53	13,5	.80	20,4	15654					15654B	HPLPC 201-098	.98	25,0									
5/16-18	M8	.250	6,4	.07	1,8	.26	6,5	15656	15656B	HPLPC 250-047	.24	6,0	.47	12,0	.63	16,0	12.4	55	47.3	210	
				.14	3,5	.41	10,5	15658	15658B	HPLPC 250-063			.63	16,0							
				.21	5,3	.49	12,5	15660	15660B	HPLPC 250-071			.71	18,0							
				.32	8,0	.57	14,5	15662	15662B	HPLPC 250-079			.79	20,0							
				.51	13,0	.77	19,5	15664	15664B	HPLPC 250-098			.98	25,0							
				.70	17,7	.96	24,5	15666	15666B	HPLPC 250-118			1.18	30,0							
				.90	22,9	1.16	29,5	15668	15668B	HPLPC 250-138			1.38	35,0							