



Heyco® Feet of Strength Feet with Snap-In Locking Fingers

- **Snap-in design** eliminates the installation labor needed for a screw or a rivet saving assembly time and equipment.
- Superior mounting approach as the Snap-In Bumper mounts securely into the panel while providing a strong mechanical support to the bumper when used as a mounting foot for electronic enclosures.
- Superior hold versus adhesive backed or screw/rivet bumpers.
- Designed to fit snugly into panel and is dust tight.
- Snap-In Bumpers are skid and scratch resistant and will not mark or stain surfaces.
- Lock firmly into enclosure.
- Quick and easy installation.
- Suitable for metal or plastic panels.
- Bumper constructed of EPDM rubber.
- Part Description Key: FSSI XX-YY-ZZ where XX = Overall Height (inches), YY = Mounting Hole Diameter (inches) and ZZ = Maximum Panel Thickness (inches)

PART DIMENSIONS				PANEL DIMENSIONS				PART NO. Black	DESCRIPTION		
A Overall Height		B Top Diameter		Mounting Hole Diameter	Thickness Range		Minimum			Maximum	
in.	mm.	in.	mm.		in.	mm.		in.	mm.		
FSSI Series											
.19	4,7	.812	20,6	.312	7,9	.03	0,8	.06	1,6	G3016	FSSI 19-31-06
.25	6,3	.812	20,6	.312	7,9	.03	0,8	.06	1,6	G3017	FSSI 25-31-06
.38	9,5	.812	20,6	.312	7,9	.03	0,8	.06	1,6	G3018	FSSI 38-31-06

Standard color black.

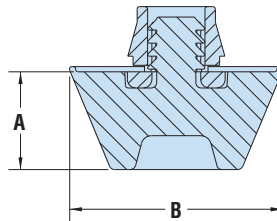

Snap-In

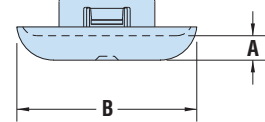

Low Profile Snap-In

Low Profile Feet with Snap-In Locking Fingers

- **The low profile snap-in design** requires no screws or adhesives to securely mount into a metal or plastic base.
- The TPE top provides a durable, non-skid surface.
- Snap-In Feet ensure a liquid tight seal and can be used for indoor or outdoor applications.
- Part Description Key: LTBP XXX-YYY where XXX = Mounting Hole Diameter (inches) and YYY = Maximum Panel Thickness (inches)



PART DIMENSIONS				PANEL DIMENSIONS				PART NO. Black	DESCRIPTION		
A Overall Height		B Top Diameter		Mounting Hole Diameter	Thickness Range		Minimum			Maximum	
in.	mm.	in.	mm.		in.	mm.		in.	mm.		
LTBP Series											
.13	3,2	.55	14,0	.500	12,7	.02	0,5	.06	1,6	C2008	LTBP 500-063
						.06	1,6	.25	6,4	C2058	LTBP 500-250
		.66	16,8	.625	15,9	.02	0,5	.06	1,6	C2012	LTBP 625-063
						.06	1,6	.25	6,4	C2062	LTBP 625-250
		.78	19,8	.750	19,1	.02	0,5	.06	1,6	C2016	LTBP 750-063
						.06	1,6	.25	6,4	C2066	LTBP 750-250
		.90	22,9	.875	22,2	.02	0,5	.06	1,6	C2020	LTBP 875-063
						.06	1,6	.25	6,4	C2070	LTBP 875-250
		1.05	26,7	1.000	25,4	.02	0,5	.06	1,6	C2022	LTBP 1000-063
						.06	1,6	.25	6,4	C2072	LTBP 1000-250
1.16	29,5	1.093	27,8	.02	0,5	.06	1,6	C2024	LTBP 1093-063		
				.06	1,6	.25	6,4	C2074	LTBP 1093-250		

Standard color black.

Quick Specs

Material	FSSI Series: EPDM Rubber insert, Nylon 6/6 body LTBP Series: Nylon 6/6 and TPE co-molding
Flammability Rating	HB
Temperature Range	-40°F (-40°C) to 221°F (105°C)
IP Rating	IP 67/68 (LTBP only)